

Dimensions

Unless otherwise specified, a tolerance of $\pm 0.4\text{mm}$ applies to all dimensions.

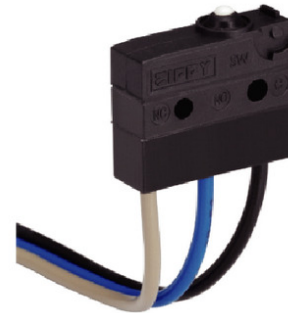

Contact Configuration

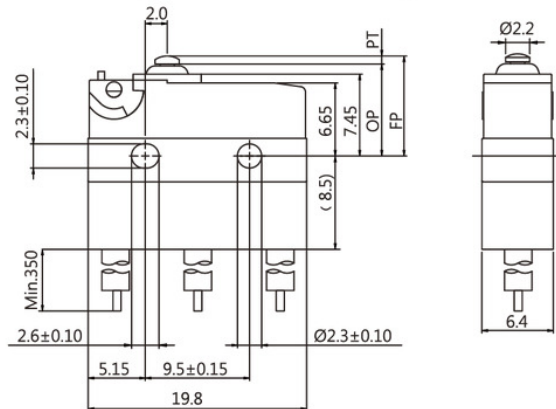

Specifications

Operating frequency(mechanical):

120 Operation / min

Operating frequency(electrical):

10~30 Operation / min

Contact resistance:

30m Ω (max)

Insulation resistance(at 500 VDC)

100M Ω (Min)

Service life(mechanical)

Min. 2,000,000 Operations

Service life(electrical)

Min. 10,000 Operations

Rating

5A/6A 125/250 VAC



Application

- Drives for beds, tables and roller shutters
- Servo drives
- Power tools
- Recreational equipment
- Vacuum cleaners
- Small household appliances
- Vending machines
- Medical devices
- HVAC technology
- Automotive applications

Order Information

S	W	0	5	S	0	0	A	0	E	A	0	0	1	Z		
SERIES PREFIX	C O D E	RATING CURRENT	C O D E	OPERATING FORCE	C O D E	ACTUATOR TYPE	C O D E	WIRE SIDE	C O D E	CIRCUIT ARRANGEMENT	C O D E	AWG TYPE	C O D E	UL NUMBER	SERIAL CODE	ROHS CODE
	05	5A 125/250 VAC 6A 125/250 VAC	S	STANDARD	00		A		0	S.P.D.T.	E	20	A	UL1007		
					01				1	S.P.S.T. NO	F	22	B	UL1015		
					02				2	S.P.S.T. NC	G	24	C	UL1430		
					03						H	26	D	UL1061		
					04								F	AV		
					05											
					06											
					07											
					08											
					09											

Operating Characteristics

SWITCH TYPE	PART SUFFIX	OF Max. (gf)	OP (mm)	PT Max. (mm)	OT Min. (mm)	MD Max. (mm)	FP Max. (mm)	RF Min. (gf)
SW-05S-00 □□ -Z		203	8.4±0.3	1.2	0.6	0.2	9.9	50
SW-05S-01 □□ -Z		82	8.8±1.1	4.3	0.9	0.6	12.0	16
SW-05S-02 □□ -Z		66	8.8±1.2	4.8	1.0	0.7	12.4	13
SW-05S-03 □□ -Z		54	8.8±1.6	6.3	1.6	0.9	13.5	11
SW-05S-04 □□ -Z		68	10.7±1.2	4.6	1.0	0.65	14.1	14

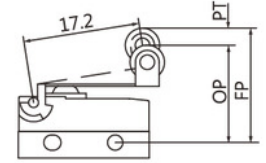
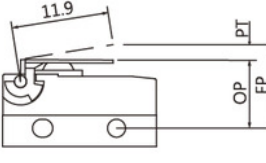
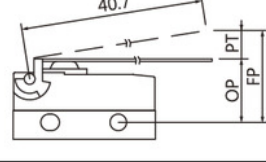
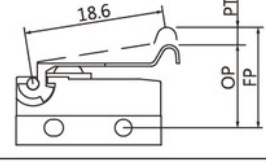
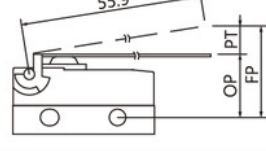
SWITCH TYPE	PART SUFFIX	OF Max. (gf)	OP (mm)	PT Max. (mm)	OT Min. (mm)	MD Max. (mm)	FP Max. (mm)	RF Min. (gf)
SW-05S-05 □□ -Z		72	14.5±1.1	4.3	0.9	0.6	17.7	15
SW-05S-06 □□ -Z		98	8.8±0.9	3.2	0.6	0.5	11.1	21
SW-05S-07 □□ -Z		39	8.8±2.6	10.1	2.1	2.3	16.3	8
SW-05S-08 □□ -Z		68	11.3±1.3	4.9	0.95	0.8	14.9	13
SW-05S-09 □□ -Z		33	8.8±3.5	13.8	2.9	3.6	19.1	7