

Operating Instructions

English translation

Dimensions

Unless otherwise specified, a tolerance of $\pm 0.4\text{mm}$ applies to all dimensions.

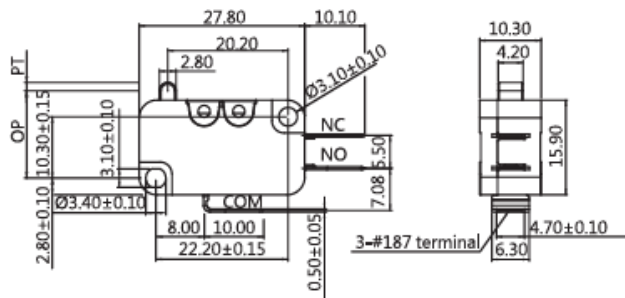

Contact Configuration

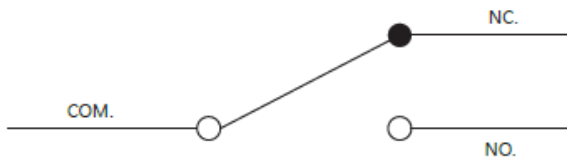

Mounting Holes

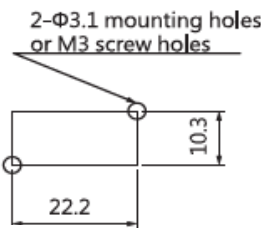

Certificate Information

Model Name	UL - cUL	ENEC
VA2-P1	0.1RA 125/250VAC $\mu\text{T}125\ 1\text{E}4$	0.1A 125/250VAC $\mu\text{T}125\ 1\text{E}4$
VA2-03	3RA 125/250VAC $\mu\text{T}125\ 1\text{E}4$	3A 125/250VAC $\mu\text{T}125\ 1\text{E}4$
VA2-06	6RA 125/250VAC $\mu\text{T}125\ 1\text{E}4$	6A 125/250VAC $\mu\text{T}125\ 1\text{E}4$
VA2-10	10RA 125/250VAC $\mu\text{T}125\ 1\text{E}4$	10(4)A 125/250VAC $\mu\text{T}125\ 1\text{E}4$
VA2-16	16RA 16GPA 125/250VAC $\mu\text{T}125\ 1\text{E}4$ 1/2HP 125/250VAC $\mu\text{T}55\ 1\text{E}4$	16(4)A125/250VAC $\mu\text{T}125\ 1\text{E}4$
VA2-20	20RA 125/250VAC $\mu\text{T}125\ 1\text{E}4$ 1/2HP 125/250VAC $\mu\text{T}55\ 1\text{E}4$	20A 125/250VAC $\mu\text{T}125\ 1\text{E}4$
VA2-26	26RA 125/250VAC $\mu\text{T}55\ 1\text{E}4$	26A 125/250VAC $\mu\text{T}55\ 1\text{E}4$
VA2-A03	3GPA 125/250VAC $\mu\text{T}85\ 1\text{E}4$	3A 125/250VAC $\mu\text{T}85\ 1\text{E}4$
VA2-A06	6GPA 125/250VAC $\mu\text{T}85\ 1\text{E}4$	6A 125/250VAC $\mu\text{T}85\ 1\text{E}4$
VA2-T6	6RA 125/250VAC $\mu\text{T}200\ 1\text{E}4$	6A 125/250VAC $\mu\text{T}200\ 1\text{E}4$

Specifications

Contact Resistance(initial)

Max. 100 m Ω

Measured by ohm meter - open voltage < 1VDC, driver current -100 mA

Insulation Resistance (at 500 VDC / minute)

Min. 100 M Ω

Dielectric Strength

Min. 500VAC(50-60HZ)/minute between Live parts.

Min. 1500VAC(50-60HZ)/minute between Live parts and dead metal parts

Operating Temperature Range

-40°C to 125°C (with no icing)

Vibration

10~55Hz, displacement 0.75 mm (p-p)

Electrical Service Life

Min. 10,000 operations

Electrical Operating Frequency

10~30 operations per minute

Mechanical Service Life

Min. 1,000,000 operations

Mechanical Operating Frequency

120 operations per minute

Operating application of the switch

Set the switch pushing distance from 60% to 90% of the specified OT value

Applications

Joystick, TV Game, Time Recorder, Air Conditioner, Food Processor, Juice Maker, Alarm, Mixer, Shredder Machine

The selection of rating & force

MODEL	Rating	B	D	N	L	S	H	Q
VA2	0.1A	*	*	*	*	*	*	*
	3A	*	*	*	*	*	*	*
	6A		*	*	*	*	*	*
	10A 10(4)A				*	*	*	*
	16A 16(4)A				*	*	*	*
	20A					*	*	*
	26A						*	*
6A T200						*	*	*

NOTE : The Symbol " * " to represent the result is accepted

Terminal Types

A TYPE

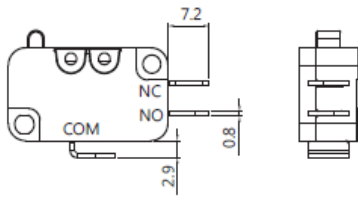

STANDARD

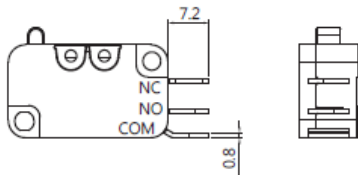

SIDE OUT

C TYPE
250 terminal
(6.3x0.8)

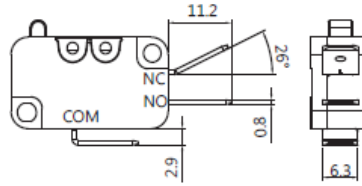

STANDARD

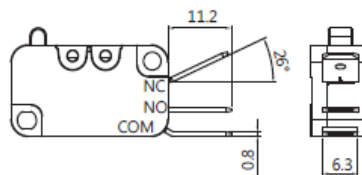

SIDE OUT

D TYPE
187 terminal
(4.7x0.5)

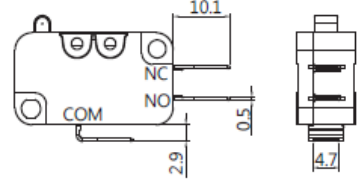

STANDARD

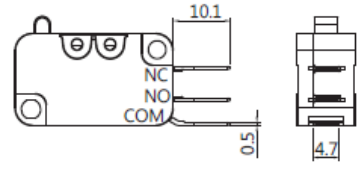

SIDE OUT

E TYPE
250 terminal
(6.3x0.8)

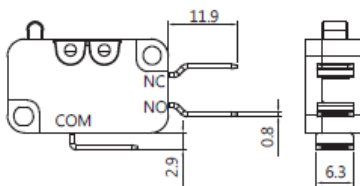

STANDARD

F TYPE
250 terminal
(6.3x0.8)

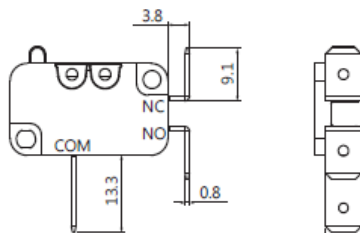

STANDARD

I TYPE
187 terminal
(4.7x0.8)

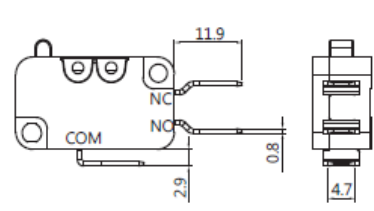

STANDARD

H TYPE
187 terminal
(4.7x0.8)

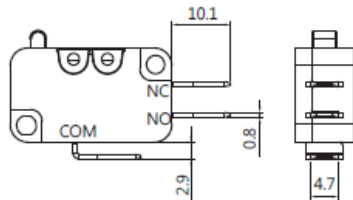

STANDARD

R TYPE
250 terminal
(6.3x0.8)

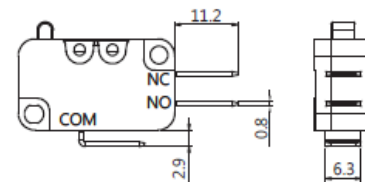

STANDARD

J TYPE
250 terminal
(6.0x0.8)

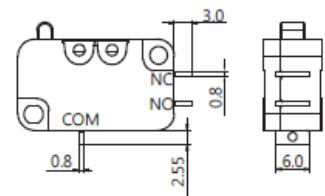

STANDARD

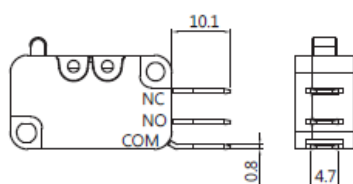

SIDE OUT

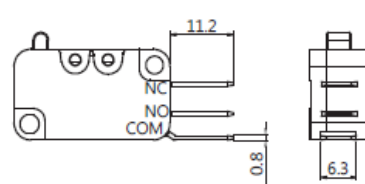

SIDE OUT

L TYPE
187 terminal
(4.7x0.5)

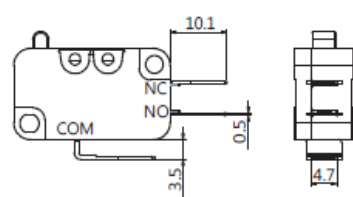

STANDARD

Ordering Information

SERIES PREFIX	C O D E	RATING CURRENT	C O D E	OPERATING FORCE	C O D E	EXTERIOR TYPE	C O D E	MOUNTING HOLES TYPE	C O D E	ACTUATOR TYPE	C O D E	TERMINAL TYPE	C O D E	CIRCUIT ARRANGEMENT	ROHS CODE	
VA2	P1	0.1A 125/250VAC T125	Q	HEAVIER	0	STANDARD TERMINAL NO ACTUATOR		MOUNTING HOLES Ø3.1	00	No Lever	A	STANDARD		0	S.P.D.T	
	03	3A 125/250VAC T125	H	HEAVY	1	STANDARD TERMINAL ACTUATOR AWAY BUTTON	A	MOUNTING HOLES Ø2.9	01			STANDARD	H	1	S.P.S.T NO	
	06	6A 125/250VAC T125	S	STANDARD	2	STANDARD TERMINAL ACTUATOR NEAR BUTTON			02			SIDE OUT		2	S.P.S.T NC	
	10	10A 10(4)A 125/250VAC T125	L	LIGHT	3	SIDE OUT TERMINAL NO ACTUATOR			03		C	STANDARD	I			
	16	16A 16(4)A 125/250VAC T125	N	SLIGHT	4	SIDE OUT TERMINAL ACTUATOR AWAY BUTTON			04			STANDARD				
	20	20A 125/250VAC T125	D	LIGHTNESS	5	SIDE OUT TERMINAL ACTUATOR NEAR BUTTON			...			STANDARD	J			
	26	26A 125/250VAC T55	B	EXTREMELY LIGHTNESS	6	SPECIAL TERMINAL NO ACTUATOR						STANDARD	L			
	A03	3A 125/250VAC T85			7	SPECIAL TERMINAL ACTUATOR AWAY BUTTON						STANDARD	R			
	A06	6A 125/250VAC T85			8	SPECIAL TERMINAL ACTUATOR NEAR BUTTON						STANDARD				
	T6	6A 125/250VAC T200										STANDARD				

# NOTE		
ITEM	RATING CURRENT	OPERATING FORCE
1	Code:P1	ALL
2	Code:03	ALL
3	Code:06	D,N,L,S,H,Q
4	Code:10	L,S,H,Q
5	Code:16	L,S,H,Q
6	Code:20	S,H,Q
7	Code:26	Q
8	Code:A03	ALL
9	Code:A06	D,N,L,S,H,Q
10	Code:T6	S,H,Q

Operating Characteristics

SWITCH TYPE	PART SUFFIX	OF Max. (gf)							OP (mm)	PT Max. (mm)	OT Min. (mm)	MD Max. (mm)
		B	D	N	L	S	H	Q				
VA2- □□□ 0-00D0-Z		18	45	75	110	170	230	330	14.7±0.5	1.72	0.8	0.4
VA2- □□□ 1-01D0-Z		18	45	75	110	170	230	330	15.3±0.5	2.8	0.6	0.5
VA2- □□□ 2-01D0-Z		8	27	43	50	85	120	175	15.3±1.1	5.2	1.55	0.9
VA2- □□□ 1-02D0-Z		8	22	37	50	86	125	180	15.3±1.5	5.9	1.6	1.0
VA2- □□□ 2-02D0-Z		5	16	25	30	51	65	90	15.3±2.3	9.7	3.1	2.2
VA2- □□□ 1-03D0-Z		6	13	25	30	49	70	120	15.3±2.5	9.3	-	2.1
VA2- □□□ 2-03D0-Z		4	8	15	20	30	35	50	15.3±4.3	16.2	-	3.5
VA2- □□□ 1-04D0-Z		10	28	43	65	110	140	205	18.7±1.5	5.5	1.4	1.1
VA2- □□□ 2-04D0-Z		7	16	24	35	56	70	100	18.7±2.1	8.7	3.2	1.7
VA2- □□□ 1-05D0-Z		20	55	80	110	170	230	330	20.7±0.8	2.7	0.6	0.45
VA2- □□□ 2-05D0-Z		8	35	55	70	100	120	175	20.7±1.1	4.65	1.4	0.8
VA2- □□□ 1-06D0-Z		8	30	45	65	100	125	180	20.7±1.5	4.2	1.6	1.25
VA2- □□□ 2-06D0-Z		7	20	30	40	51	65	90	20.7±2.2	9.3	2.8	1.8